

BEFORE YOU START:

- Please check local electrical codes before beginning
- Turn power off before installing
- Make sure to use proper rated wire

TOOLS NEEDED:

- Phillips Screwdriver
- Wire Cutter and Stripper

PLUG IN INSTALLATION

(Skip this step if you are using
HARDWIRE INSTALLATION:

1. Layout where fixture(s) are to be placed, insuring that first fixture is mounted within 6 feet of an outlet. Remove plastic receptacle cap that covers the INPUT socket where you will plug in power cord. (FIG. 1)

2. Plug-in power cord to the INPUT socket. Do not force, it should plug-in easily. (FIG. 2)

3. Mount fixture to under cabinet or where you plan to locate fixture. Plug power cord into wall outlet. (FIG. 3).

4. Connect multiple fixtures using optional flexible fixture to fixture connectors. Do not exceed max. of 200W per run.

5. Adjust white color (Kelvin) levels.

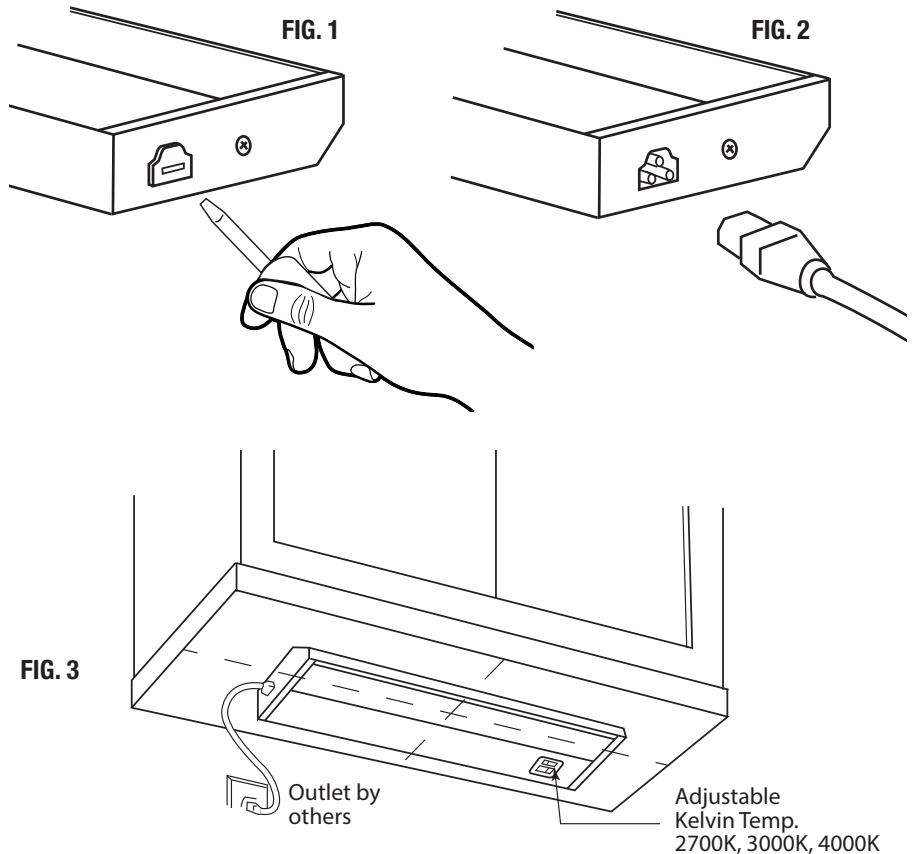

HARDWIRE INSTALLATION:

1. Open up wireway cut-out and wiring compartment (there are screws located on each side of fixture) (FIG. 4) and pull out 3 modular wire connectors (black, white and green). Modular (push-in) connectors are suitable for #12-14 AWG solid core wire. Strip back jacket on AC supply wires 3/8" and use Wago® (push-in) connector to connect wires (BLACK to BLACK, WHITE to WHITE, GREEN to GREEN). WARNING: DO NOT MIX WIRES OR CHANGE POLARITY. Please reference FIG. 5.

2. Tuck all wires back into wiring compartment, and re-attach wiring compartment. WARNING: ENSURE ALL THE WIRES AND CONNECTIONS ARE SEALED PROPERLY INSIDE THE FIXTURE WITHOUT PINCHING ANY WIRES.

