



### READ BEFORE YOU START

THIS LUMINAIRE IS TO BE INSTALLED IN ACCORDANCE WITH LOCAL CODES AND THE NATIONAL ELECTRIC CODE (NFPA70). FAILURE TO FOLLOW THESE CODES AND INSTRUCTIONS MAY RESULT IN SERIOUS INJURY, PROPERTY DAMAGE AND VOID THE WARRANTY. THESE INSTRUCTIONS DO NOT COVER ALL TYPES OF INSTALLATION AND MOUNTING, OPERATION OR MAINTENANCE.



### WARNING! - HOT

THE LUMINAIRE, LENS, AND SURROUNDING METAL COMPONENTS CAN BECOME VERY HOT DURING OPERATION, POSING A BURN RISK. AVOID INSTALLING FIXTURES IN AREAS ACCESSIBLE TO CHILDREN, ESPECIALLY WHEN USING HIGH-WATTAGE LAMPS, AND KEEP FLAMMABLE MATERIALS CLEAR OF THE UNIT. ALWAYS ALLOW THE FIXTURE TO COOL COMPLETELY BEFORE HANDLING OR PERFORMING MAINTENANCE.



### WARNING! - SHOCK HAZARD

DO NOT INSTALL WITHIN 10 FEET (3M) OF POOLS OR SPAS

TURN POWER OFF BEFORE INSTALLING OR SERVICING COMPONENTS.

DO NOT MAKE CONNECTIONS UNDERWATER UNLESS USING AN UNDERWATER-RATED SPLICE

## INSTALLATION STEPS

### Step 1: Unpack and Verify Parts

Remove all components from the packaging and confirm that all necessary parts are included. (FIG 1)

### Step 2: Remove Faceplate Screws

Locate the four screws on the front face of the fixture. Use a Phillips screwdriver to unscrew and remove all the screws.

### Step 3: Insert the MR16 Lamp

Insert the GM Lighting Series MR16 lamp (MAX 7W) into the fixture socket by aligning the pins with the slots. Press down firmly until fully seated.

### TOOLS/SUPPLIES NEEDED:

- GM Lighting MR16 series lamp
- Phillips Screwdriver
- Direct-burial connectors
- Low voltage direct burial cable
- Wire cutters/strippers
- Drill

### PARTS INCLUDED:

- ILS-U100: Fixture Assembly
- Set of Mounting Screws (3)

### IMPORTANT SAFETY GUIDE:

- It is recommended to use a qualified electrician for installation or maintenance.
- Use only low-voltage landscape power supplies ( $\leq 300W$ , 25A, 12V).
- Use MR16 lamp ( $\leq 7W$  max).
- Only use wire connectors suitable for outdoor use.
- Low voltage cable is intended for shallow burial - less than 6 inches (15.2 cm).
- Not for use directly in saltwater or chemically treated water.

FIG. 1

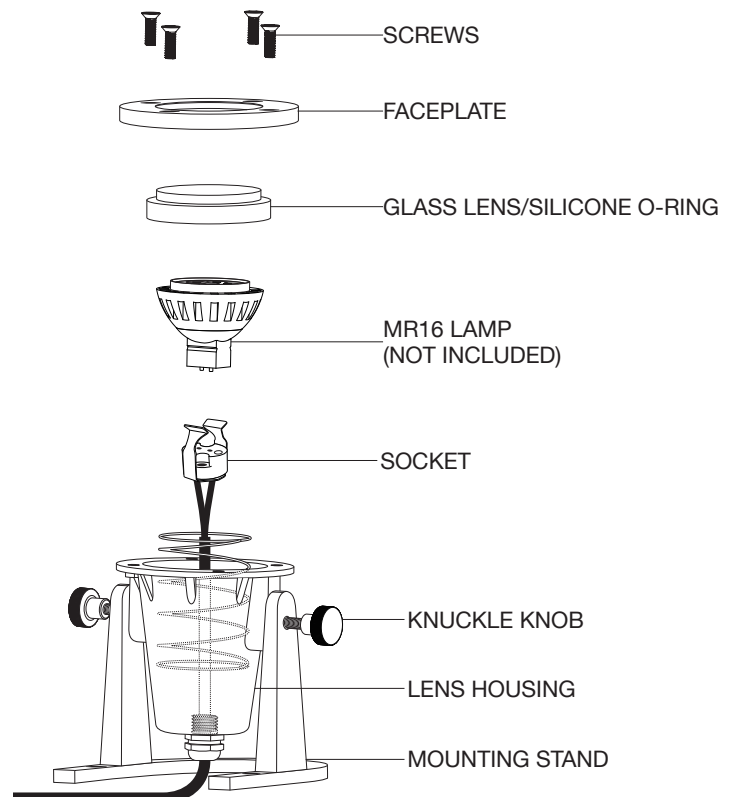

## INSTALLATION STEPS

### Step 4: Secure the Faceplate Screws in Sequence

Insert MR16 lamp into gasket on faceplate before assembling the fixture. Align the faceplate with the holes for screws and tighten all faceplate screws evenly until slight resistance is felt, then fully secure using cross pattern tightening technique (1 → 2 → 3 → 4), to evenly compress the silicone gasket and ensure a watertight seal. (FIG. 2)

**NOTE: SOME APPLICATIONS ARE NOT SUITABLE FOR PERMANENT MOUNTING, IF NOT REQUIRED SKIP TO STEP 6**

### Step 5: Mounting Fixture (If Applicable)

Position the mount in the desired location, mark the three anchor points through its holes, then align and drill the screws into the surface until snug—avoid over-tightening.

### Step 6: Trim Excess Cable for Flexibility

Use wire cutters to cut excess cable but leave extra for wire handling and repositioning of fixture.

### Step 7: Strip and Connect Wires Securely

Separate the wires and strip the insulation. Run the wires out of the water, ensuring all connections are made above the waterline. Burying the wire run is not necessary but can be done for added protection. (FIG. 3)

### Step 8: Power On and Test

Once all connections are secure, turn on the power supply to test operation. When fixture lights up adjust fixture tilt for preferred aiming/control of light beam. If the system does not light up then check connections and transformer. (FIG. 4)

FIG. 2

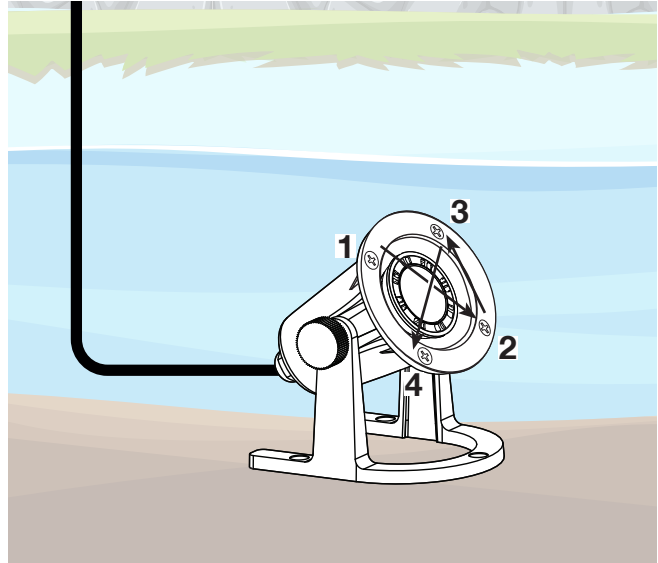

**NOTE: ORDER (1 → 2 → 3 → 4)**

FIG. 3

